

MHE-50T/EN5424

EN 54-24 Music-Horn-Speaker for Outdoor Use
in ABS / SS with 50 Watt Power

EN
54-24

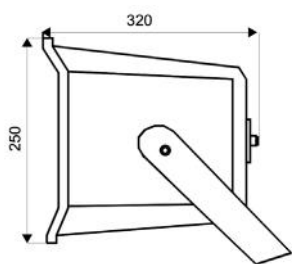
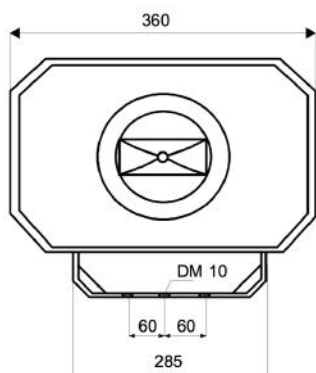

TECHNICAL DATA

MHE-50T/EN5424

Loudspeaker:	2-Way Music-Horn
Power-Consumption:	100V-50-30-15W
Frequency-Range:	90 -16 000 Hz
EN-Sensitivity 1W/4M:	85 dB
SPL max 50W/4M:	103,1 dB
SPL 1W/1M max. EASE/Ulysses:	106 dB (0,75 kHz)
SPL 50W/1M max. EASE/Ulysses:	123 dB (0,75 kHz)
Radiation H (0,5/1/2/4KHz):	40°/22°/16°/60°
Radiation V (0,5/1/2/4KHz):	110°/60°/30°/70°
EN degree:	EN Type B, weather-proof, outdoor-certificated
Dimension:	360 x 250 x 320 mm
Weight:	4,4 kg
Material:	ABS / Stainless Steel
Color:	white-grey
Certificate-Nr.:	1293-CPR-0624
Order-Nr.:	MHE-50T/EN5424

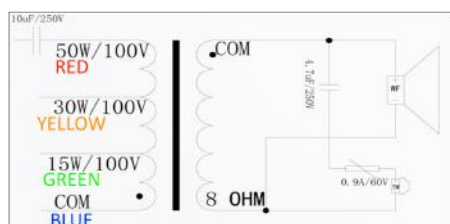

- Weather- and scratch-resistant ABS-case
- Flame retardent material acc. to EN 60695-11-20, 5VB
- Steam- / dampness-protected
- Mastholder available
- Three 100V-tappings with junction box
- Special DIN 912-ISO 4762 screws
- eramic clamp & thermal fuse by request

MHE-50T/EN5424

EN 54-24 Music-Horn-Speaker for Outdoor Use
in ABS / SS with 50 Watt Power

**ELKO
SCHMID**



Elektroakustische Komponenten

Radiation

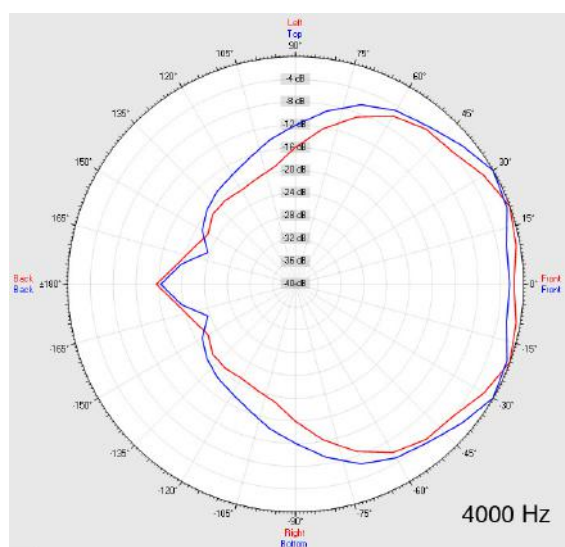
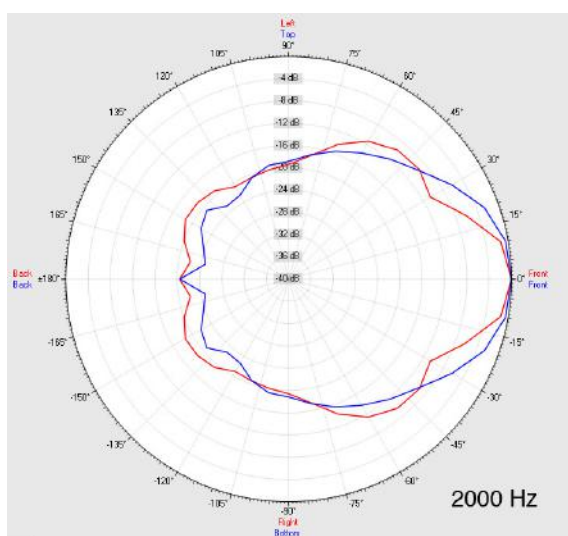
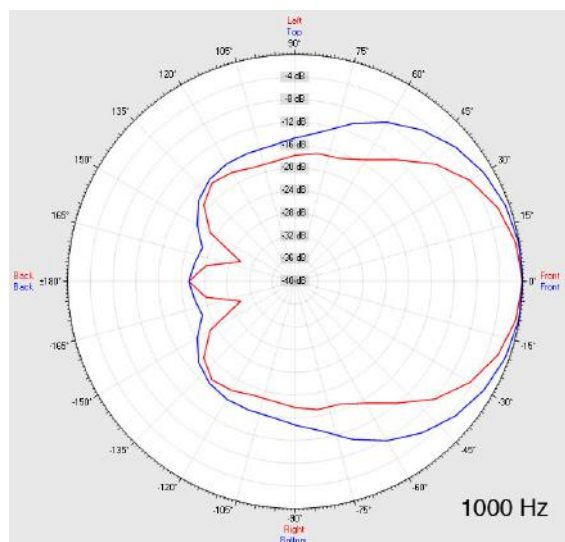
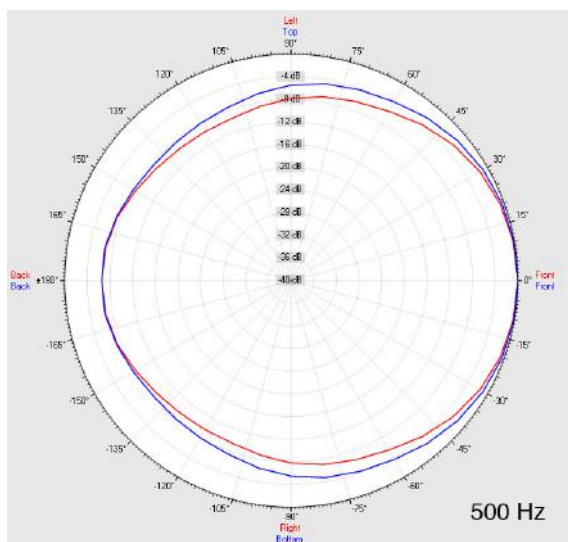

Test method	Axis	500 Hz	1000 Hz	2000 Hz	4000 Hz
EN 54-24	HOR	40°	22°	16°	60°
EN 54-24	VER	110°	60°	30°	70°
EASE/Ulysses	HOR	130°	70°	30°	110°
EASE/Ulysses	VER	190°	100°	55°	150°

MHE-50T/EN5424

EN 54-24 Music-Horn-Speaker for Outdoor Use
in ABS / SS with 50 Watt Power



Elektroakustische Komponenten

Iso-bar-Diagramm

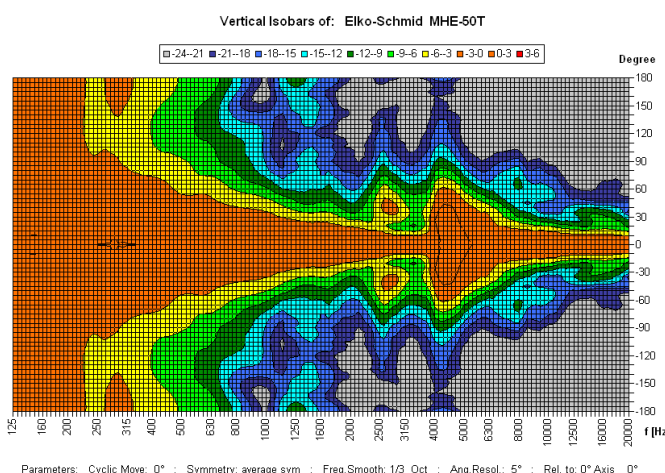
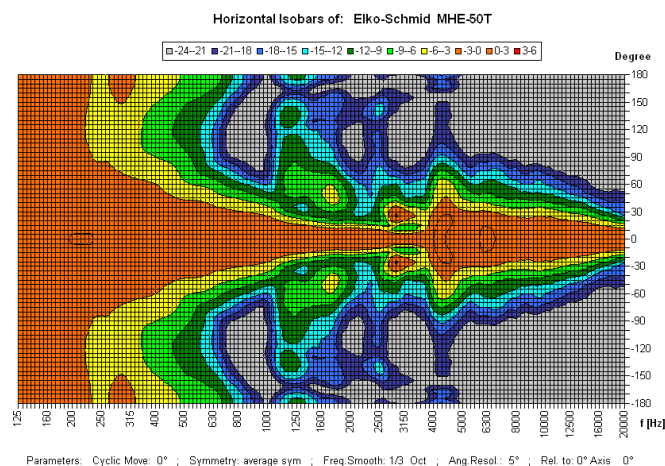

1293

Elko Schmid GmbH & Co. KG
Glauchauer Str. 30, D-08058 Zwickau

12

DoP: 498058129314-OWS-PN-0020

EN 54-24

Loudspeaker for voice alarm systems for
fire detection and fire alarm systems for buildings

MHE-50T/EN5424

Intended Option:
Type B