

# MHE-100T

Horn-Speaker for Outdoor Use  
in ABS / SS with 100 Watt Power and 2-Way - Technology

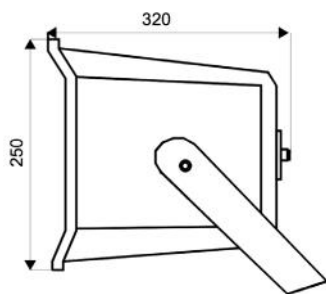

Elektroakustische Komponenten

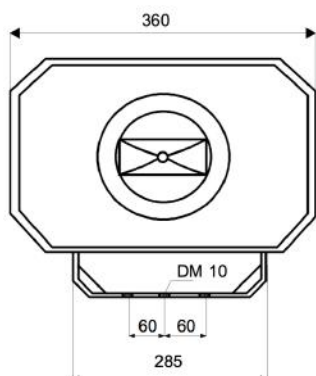

## TECHNICAL DATA

## MHE-100T

Loudspeaker:	2-Way Horn-paging
Power-Consumptio:	100V-100-50-25-12,5W
Frequency-Range:	90 -16 000 Hz
SPL 1W/1M max.:	103 dB
SPL 100W/1M max.:	123 dB
Radiation:	100° x 70° (1kHz)
Dimension:	360 mm x 250 mm x 320 mm
Weight:	4,7 kg
Material:	ABS / Stainless Steel
Color:	grey

- Weather- and scratch-resistant ABS-case
- Weather-proof & dust-proof
- Optional mast holder available
- Premium 2-way speaker-quality
- Excellent music broadcast
- High speech intelligibility
- Connection via cable
- Ceramic clamp & thermal fuse by request