

CS-50WA-DC

Column-Speaker for Outdoor Use
in ALU / SS with 2x 30 Watt Power and AB-Dual-Cone-Technique

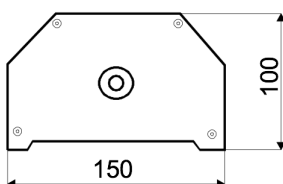

Elektroakustische Komponenten

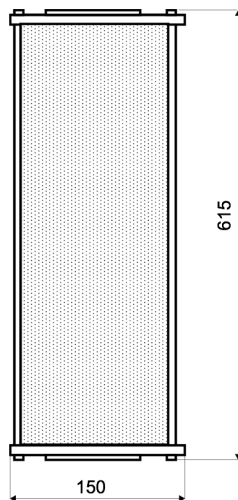

TECHNICAL DATA

CS-50WA-DC

Loudspeaker:	4x broadband with Dual Voice Coil
Power-Consumption:	2x 100V-30-15-7,5W
Frequency-Range:	70-18 000 Hz
SPL 1W/1M:	98 dB (double)
SPL 30W/1M:	115 dB (double)
Radiation H/V:	210° / 182° (1 kHz, single)
Dimension:	615 x 150 x 100 mm
Weight:	4,8 kg
Material:	ALU / Stainless Steel
Color:	black or white / Holder Stainless Steel
Order-Nr.:	CS-50WA-DC-BK
	CS-50WA-DC-WH

- 2 x 4 Dual-System-Coils over full front
- Weather-proof through Aluminium-casing
- Alu-Grill & ABS-Inner-Panel, Stainless Steel bracket & screws
- Ball-attack certified version acc. to DIN 18032-3 obtainable
- Touch-secure 100V-tappings
- Ceramic clamp & thermal fuse by request

- Always check full functionality of the line monitoring before using our dual voice coil products.